

Korniche FlatLite™ Rooflight

Installation Guide

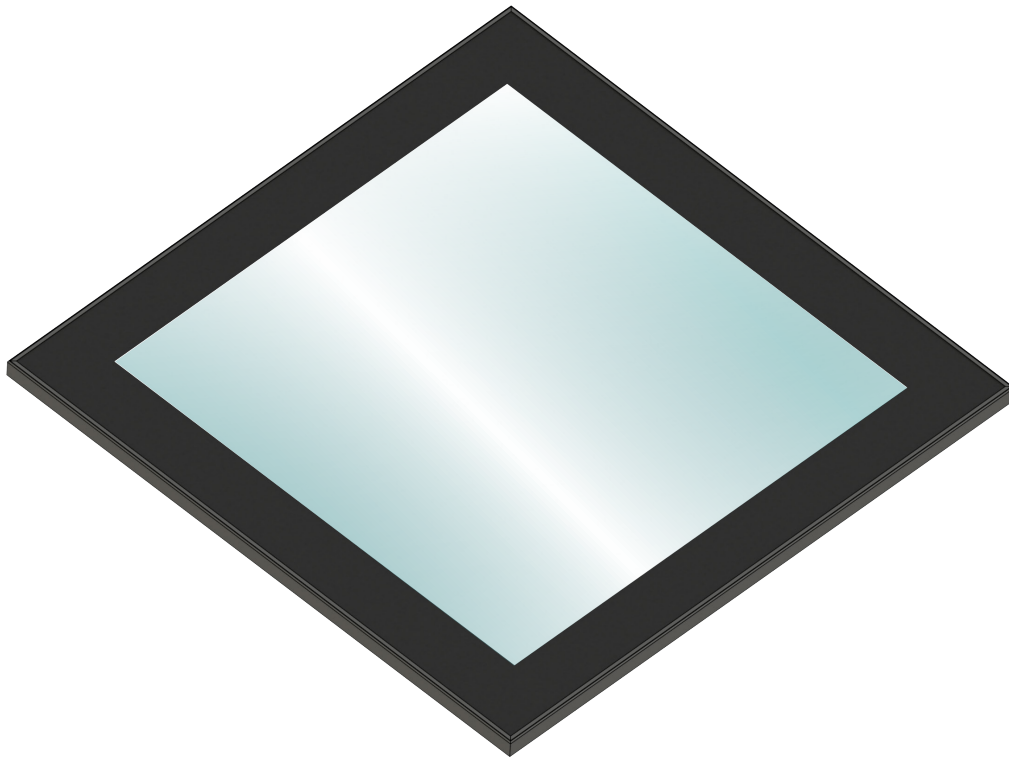

TOOLS REQUIRED

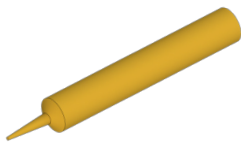

Weather Sealant

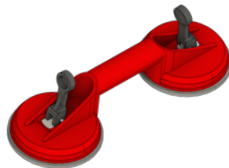

Suction Cup Lifter

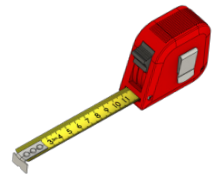

Tape Measure

PACKAGING CONTENTS

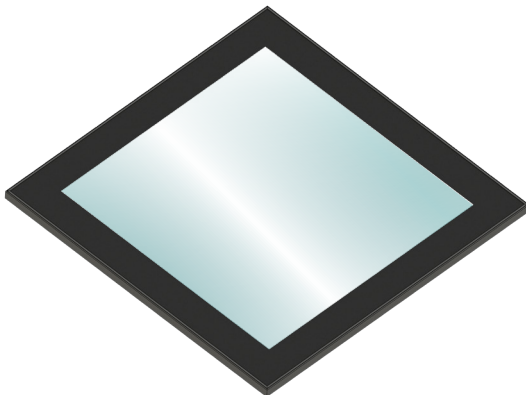

FlatLite™
Bonded Flat Glass Unit



Weather Sealant
(Recommended)

UPSTAND CRITICAL MEASUREMENTS

1

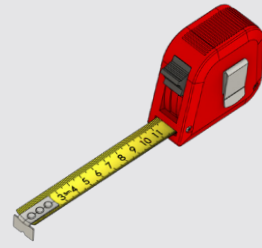

Check upstand meets specification

Recommend Angle 5°
Min Angle 3°

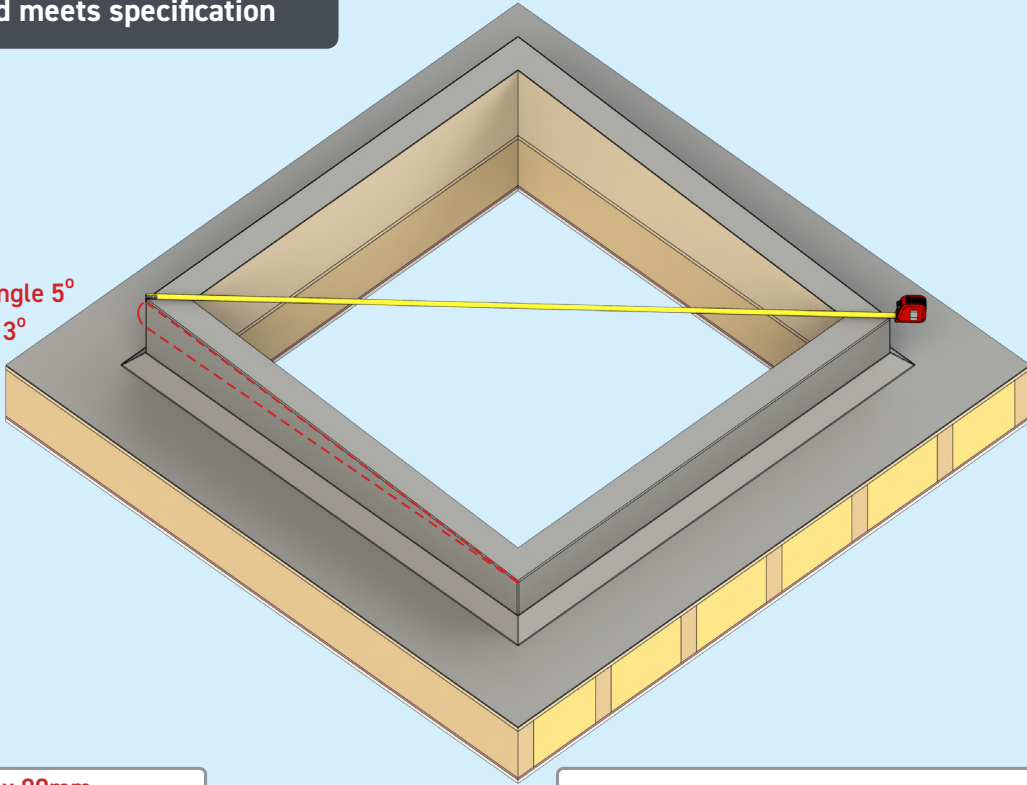

Max 80mm
Min 75mm

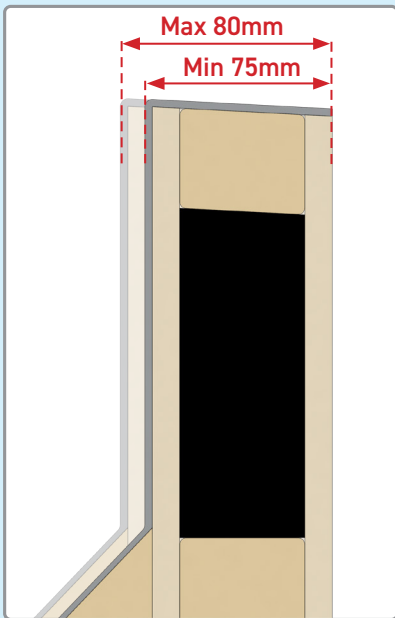

$A = B \pm 3\text{mm}$

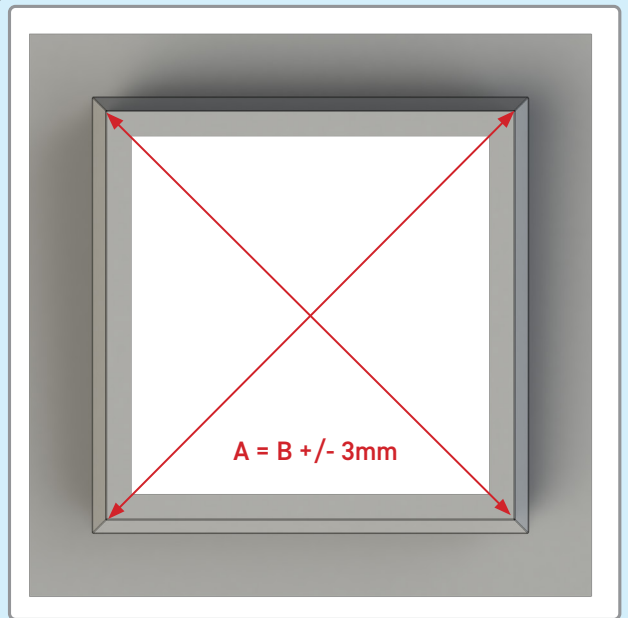

All measurements must be to specification.

FIT FLAT-GLASS UNIT TO UPSTAND

2

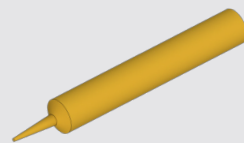

Lay bead of weather sealant onto upstand

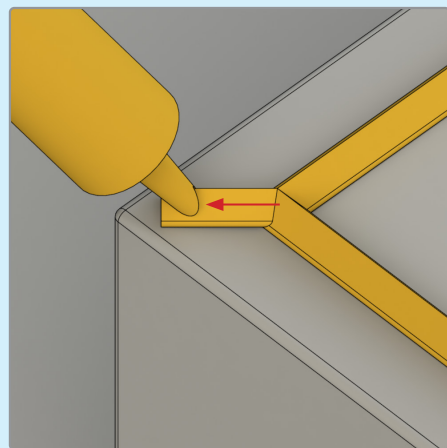
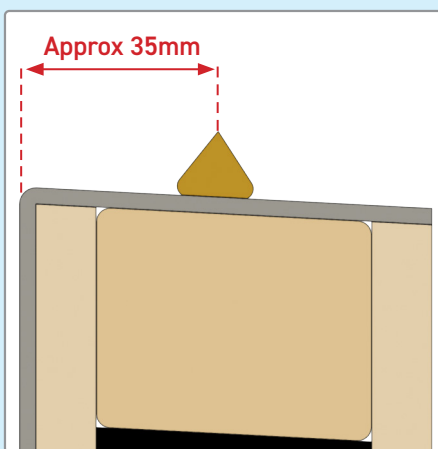
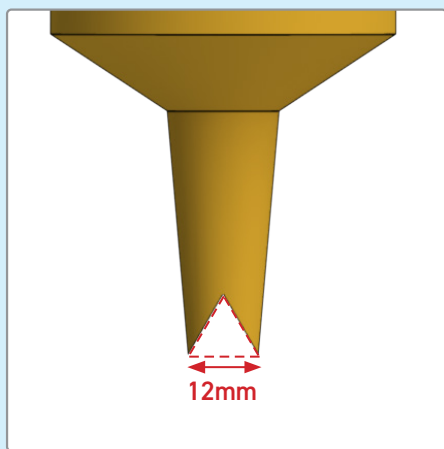
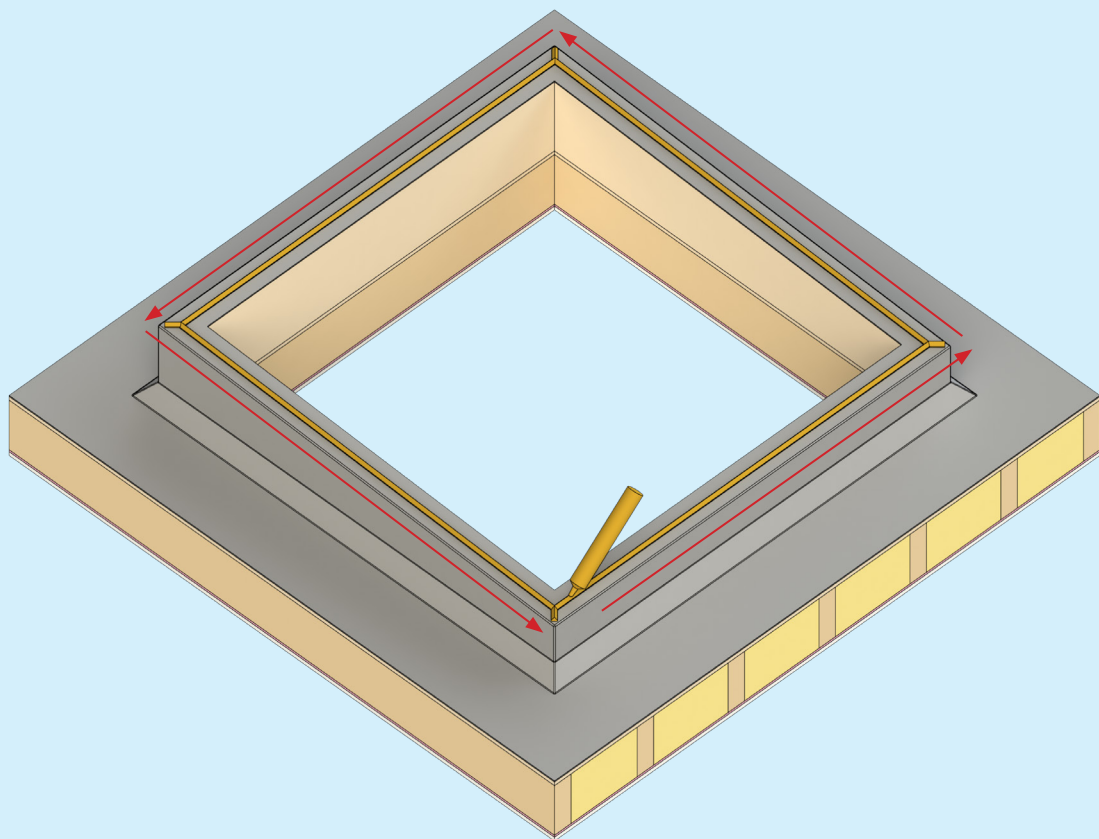

Cut nozzle in a 'V' shape.

FIT FLAT-GLASS UNIT TO UPSTAND

3

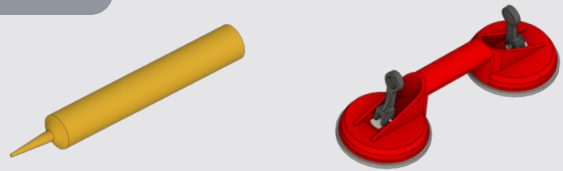

Peel off backing tape before placing Flat-glass unit onto upstand

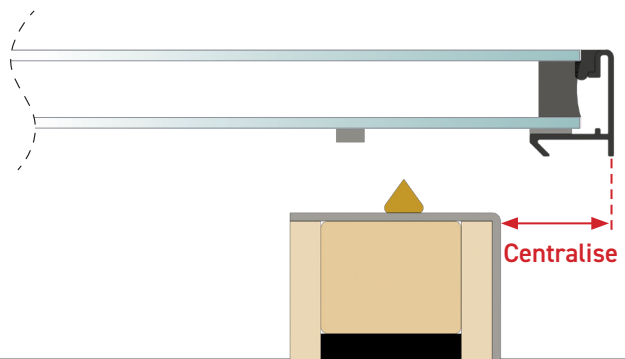
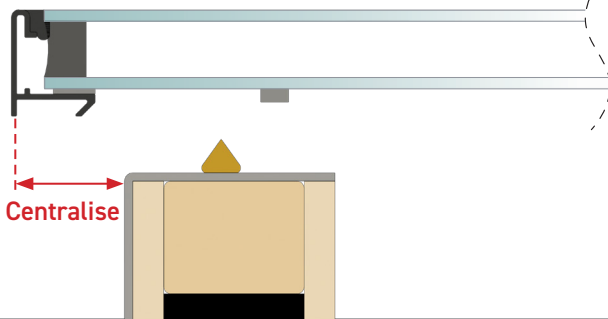
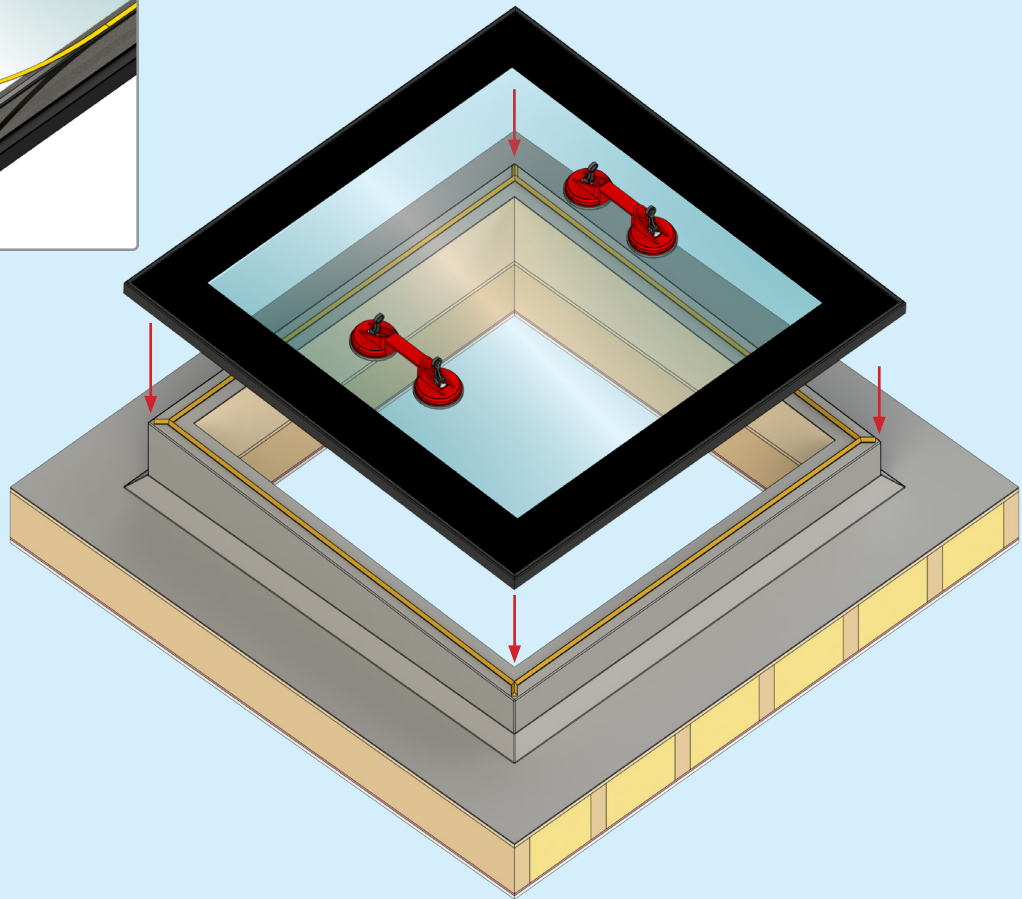
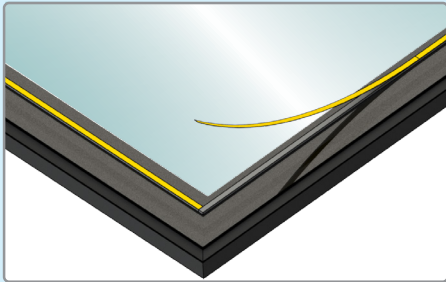

Ensure unit is centralised before applying final downwards pressure.

EXTERNAL WEATHER SEALANT

4

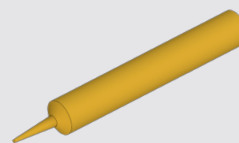

Cut nozzle and run silicone around the perimeter of the profile where shown

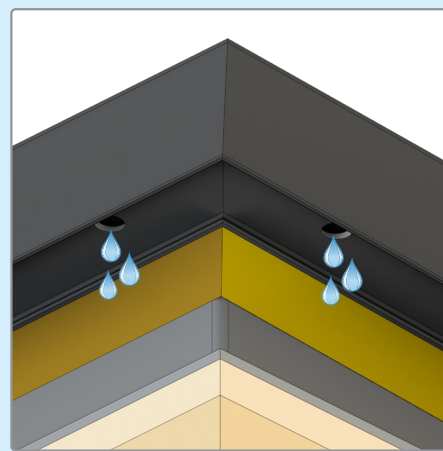
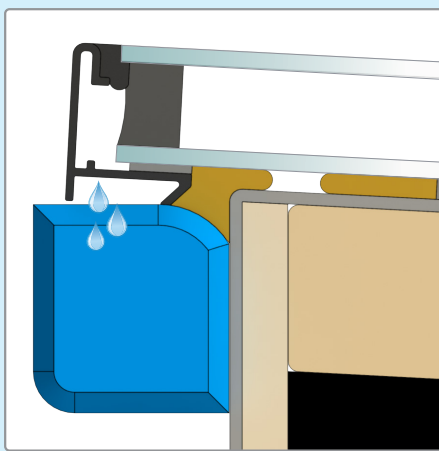
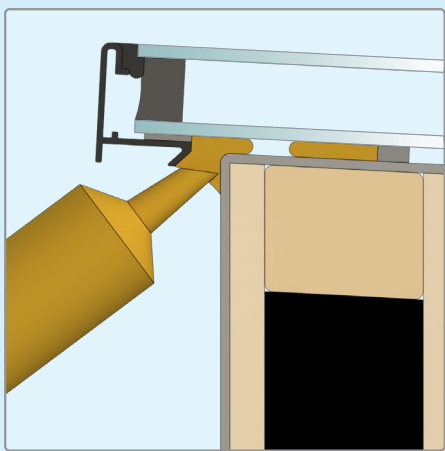
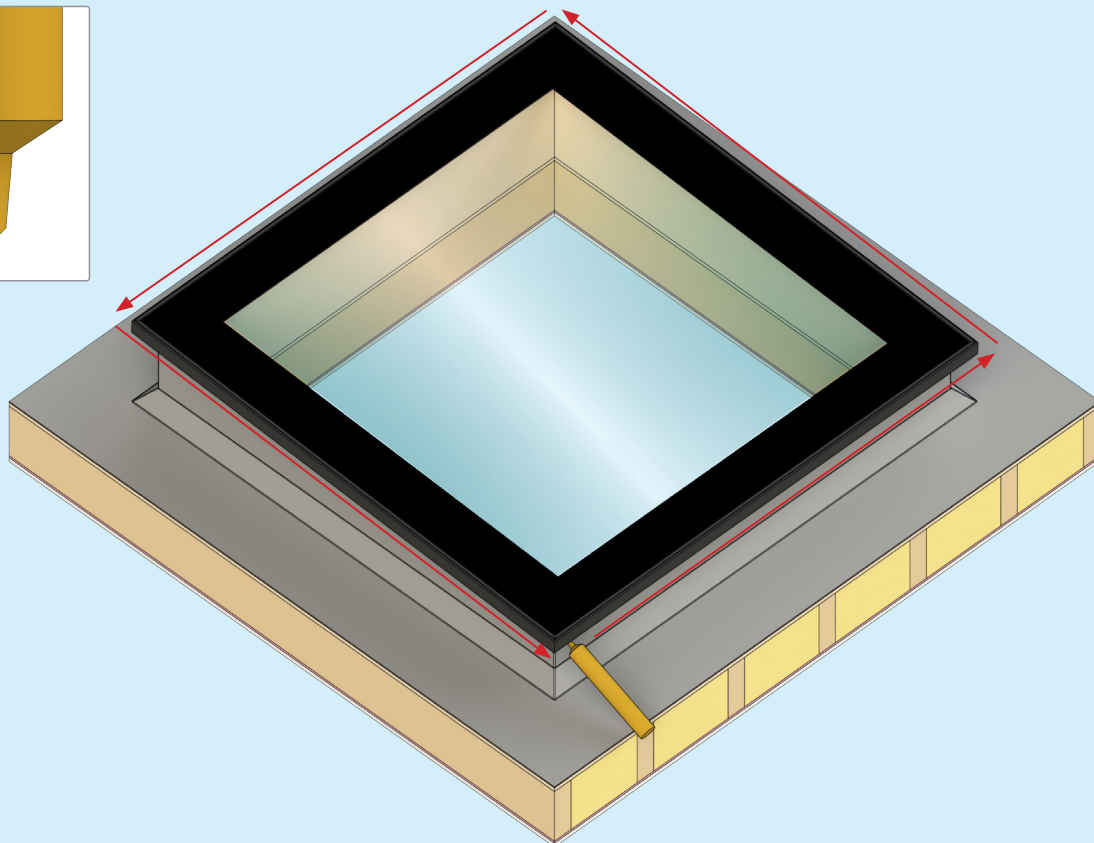
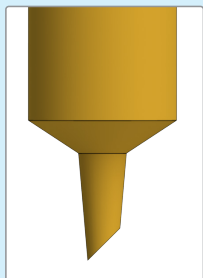

Ensure drainage holes are not blocked.

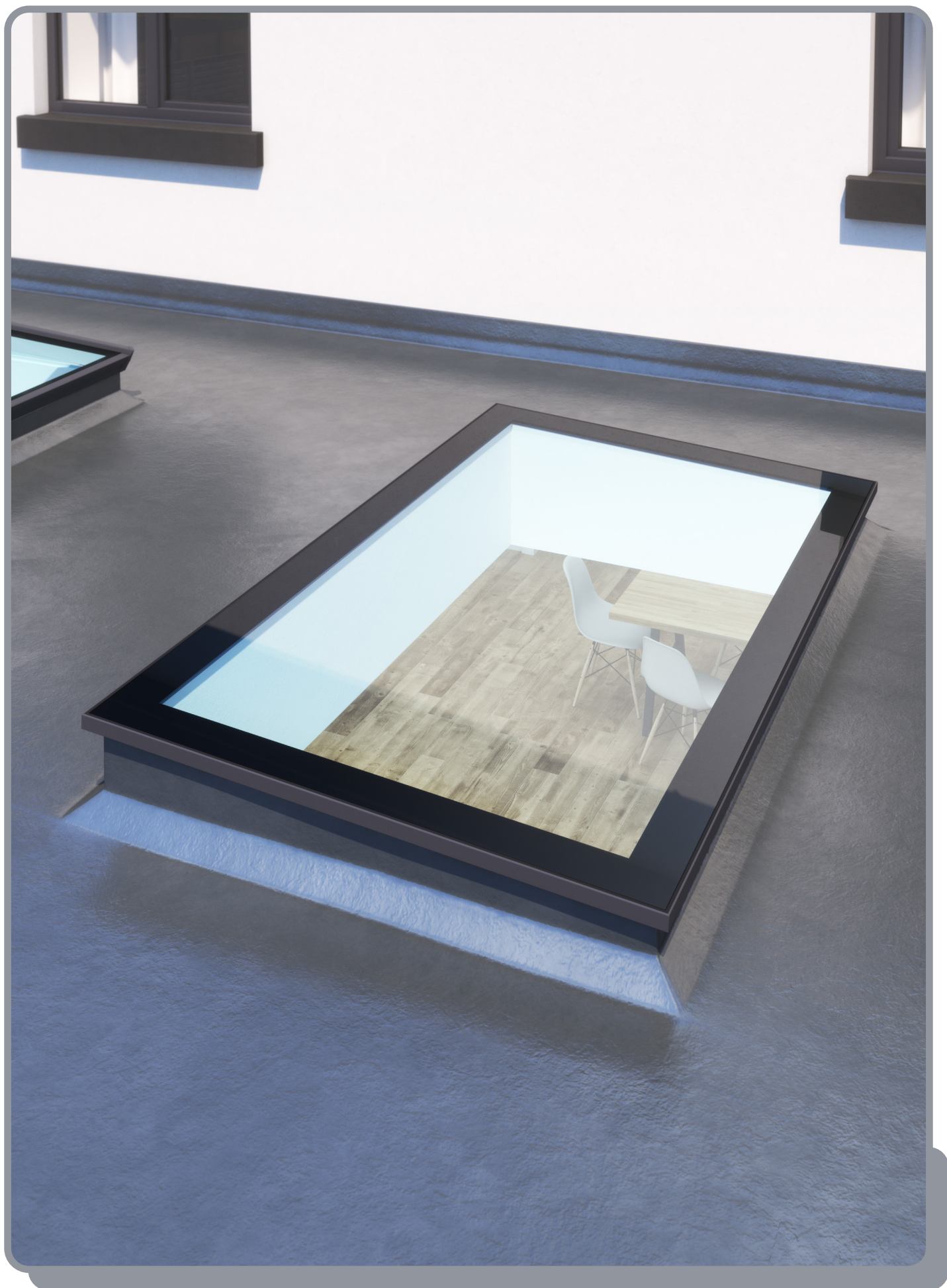



www.korniche.co.uk